

Scroll Condensing Units



- Quiet and efficient Copeland scroll hermetic compressors
- Generous wide finned, low noise level condensers supplied with protective coil coating
- Wide range of factory fitted accessories available
- Specifically designed for Australasian conditions

SR Medium / High

8 15 hp

CAPACITY (Watts) @ 32°C Ambient *

| MODEL | Nom. hp | Refrigerant | Evaporating Temp °C | | | | | | |
|--------|---------|-------------|---------------------|-------|-------|-------|-------|-------|-------|
| | | | -15 | -10 | -5 | 0 | 5 | 10 | 15 |
| SR800 | 8.0 | R134a | | 8060 | 9910 | 11990 | 14470 | 17380 | 21200 |
| | | R404A | 11630 | 13770 | 16630 | 19360 | 22810 | 25900 | |
| | | R22 | 11120 | 13270 | 15990 | 19020 | 22610 | 26060 | |
| SR900 | 9.0 | R134a | | 9660 | 11960 | 14740 | 17850 | 21260 | 24000 |
| | | R404A | 13410 | 15830 | 18990 | 22310 | 25940 | 29690 | |
| | | R22 | 12820 | 15250 | 18300 | 21920 | 25710 | 29900 | |
| SR1000 | 10.0 | R134a | | 11210 | 13870 | 17030 | 20460 | 24600 | 28070 |
| | | R404A | 15630 | 18360 | 22050 | 25700 | 29770 | 33900 | |
| | | R22 | 14950 | 17690 | 21300 | 25250 | 29510 | 34140 | |
| SR1200 | 12.0 | R134a | | 12100 | 14750 | 19100 | 22750 | 27200 | 32000 |
| | | R404A | 16940 | 21080 | 25550 | 29560 | 34180 | 38810 | |
| | | R22 | 16200 | 20330 | 24600 | 29040 | 33880 | 39090 | |
| SR1300 | 13.0 | R134a | | 13750 | 17050 | 20940 | 25130 | 29880 | 34980 |
| | | R404A | 18520 | 21950 | 26600 | 31050 | 36070 | 41270 | |
| | | R22 | 17710 | 21170 | 25700 | 30500 | 35750 | 41520 | |
| SR1500 | 15.0 | R134a | | 16060 | 20030 | 24390 | 29330 | 35200 | 41500 |
| | | R404A | 22690 | 26650 | 31970 | 37510 | 43580 | 49850 | |
| | | R22 | 21700 | 25700 | 30800 | 36850 | 43200 | 50150 | |

DIMENSIONS:

SR800, SR900, SR1000

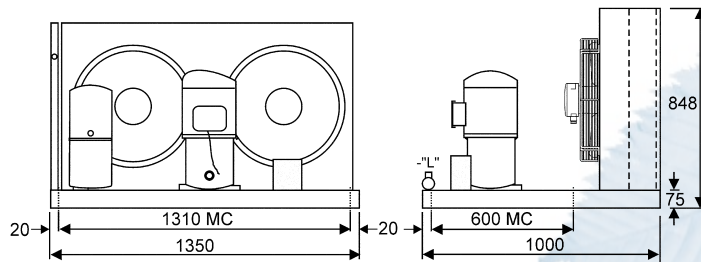

SR1200, SR1300 SR1500

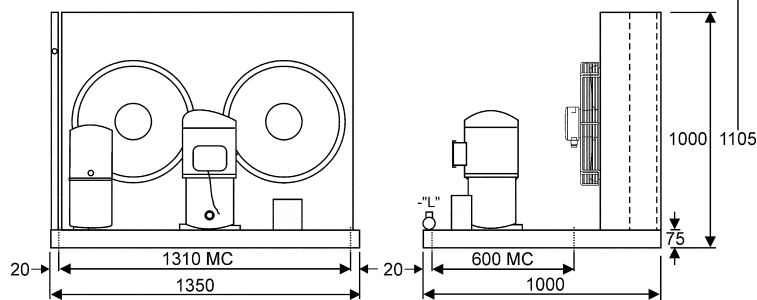

NTS (mm)
Accessories not shown

TECHNICAL DATA:

| MODEL | COMPRESSOR | | | | | | CONDENSER | | | RECEIVER | CONNECTIONS (3) | | Noise Level (dbA) (4) | Weight (kg) |
|--------|------------|--------------|--------------|--------------------------|----------|----------|---------------|---------------|------|-------------------|-----------------------|-----------------|-----------------------|-------------|
| | NOM. hp | MODEL | VOLTAGE | DISP. m ³ /hr | RLA Amps | LRA Amps | Airflow l/sec | Fan Motor (1) | | Capacity (kg) (2) | Receiver Outlet Valve | Comp Suct Valve | | |
| | | | | | | | | Watts | Amps | | | | | |
| SR800 | 8.0 | ZR94KCE-TFD | 380-420/3/50 | 22.1 | 15.9 | 95.0 | 2550 | 940 | 4.0 | 10.4 | 7/8"FSw | 1-1/8"FSw | 62 | 166 |
| SR900 | 9.0 | ZR108KCE-TFD | 380-420/3/50 | 25.2 | 16.8 | 111.0 | 2360 | 940 | 4.0 | 10.4 | 7/8"FSw | 1-3/8"FSw | 63 | 193 |
| SR1000 | 10.0 | ZR125KCE-TFD | 380-420/3/50 | 28.8 | 19.6 | 118.0 | 2360 | 940 | 4.0 | 10.4 | 7/8"FSw | 1-3/8"FSw | 64 | 198 |
| SR1200 | 12.0 | ZR144KCE-TFD | 380-420/3/50 | 33.2 | 22.3 | 118.0 | 2950 | 940 | 4.0 | 10.4 | 7/8"FSw | 1-3/8"FSw | 64 | 226 |
| SR1300 | 13.0 | ZR16M3E-TWD | 380-420/3/50 | 35.6 | 26.0 | 167.0 | 2950 | 940 | 4.0 | 10.4 | 7/8"FSw | 1-3/8"FSw | 67 | 258 |
| SR1500 | 15.0 | ZR19M3E-TWD | 380-420/3/50 | 42.1 | 28.0 | 198.0 | 3610 | 940 | 4.0 | 10.4 | 7/8"FSw | 1-5/8"FSw | 67 | 275 |

NOTES:

1. Fan motors are suitable for 220-240/1/50
2. R404A pump down capacity shown @ 80% full for 32°C liquid temperature
3. Max valve connection size shown. May reduce for different refrigerants & applications
4. All noise level ratings are "free field" based at a distance of 3 metres from source and are given as a guide only
5. *Capacity ratings are based on suction gas returning to compressor @ 20°C, without liquid sub-cooling. Ratings may be increased by approximately 1% for every 1.1°K of sub-cooling
6. Standard condensers fitted. Ratings must not be extrapolated
7. Check with Patton's nearest outlet for applications outside the specified range
8. Pictured unit configuration subject to change and selected accessory options.

The company reserves the right to make specification changes without notice. 11/03/10