

Scroll Condensing Units



- Quiet and efficient Copeland scroll hermetic compressors
- Generous wide finned, low noise level condensers supplied with protective coil coating
- Wide range of factory fitted accessories available
- Specifically designed for Australasian conditions

SR Medium / High

8 15 hp

CAPACITY (Watts) @ 38°C Ambient *

MODEL	Nom. hp	Refrigerant	Evaporating Temp °C						
			-15	-10	-5	0	5	10	15
SR800	8.0	R134a		7390	9085	10990	13260	15925	19425
		R404A	10665	12625	15240	17740	20900	23730	
		R22	10195	12170	14655	17430	20715	23875	
SR900	9.0	R134a		8860	10965	13510	16355	19480	21990
		R404A	12295	14515	17405	20445	23765	27200	
		R22	11755	13985	16770	20085	23555	27395	
SR1000	10.0	R134a		10280	12720	15610	18745	22540	25720
		R404A	14335	16835	20210	23550	27275	31060	
		R22	13710	16220	19520	23135	27035	31280	
SR1200	12.0	R134a		11095	13525	17505	20845	24920	29320
		R404A	15535	19330	23415	27085	31315	35560	
		R22	14855	18645	22545	26610	31040	35815	
SR1300	13.0	R134a		12610	15635	19190	23025	27375	32050
		R404A	16985	20130	24380	28450	33045	37810	
		R22	16240	19415	23555	27945	32720	38040	
SR1500	15.0	R134a		14725	18730	22355	26875	32250	38020
		R404A	20805	24440	29300	34370	39930	45675	
		R22	19900	23565	28230	33765	39580	45945	

DIMENSIONS:

SR800, SR900, SR1000

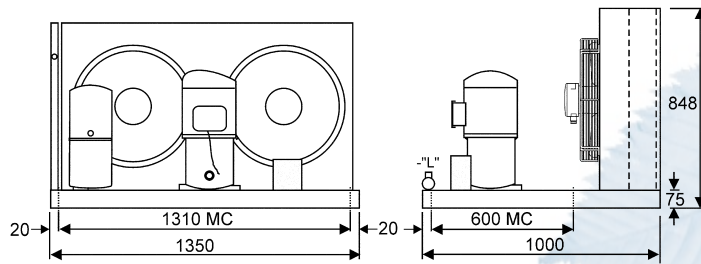

SR1200, SR1300 SR1500

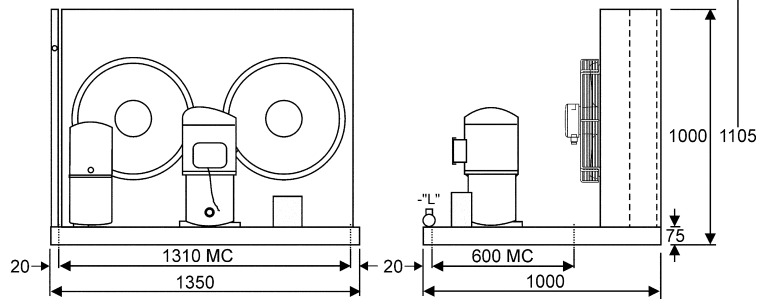

NTS (mm)
Accessories not shown

TECHNICAL DATA:

MODEL	COMPRESSOR						CONDENSER			RECEIVER	CONNECTIONS (3)		Noise Level (dbA) (4)	Weight (kg)
	NOM. hp	MODEL	VOLTAGE	DISP. m ³ /hr	RLA Amps	LRA Amps	Airflow l/sec	Fan Motor (1)		Capacity (kg) (2)	Receiver Outlet Valve	Comp Suct Valve		
								Watts	Amps					
SR800	8.0	ZR94KCE-TFD	380-420/3/50	22.1	15.9	95.0	2550	940	4.0	10.4	7/8"FSw	1-1/8"FSw	62	166
SR900	9.0	ZR108KCE-TFD	380-420/3/50	25.2	16.8	111.0	2360	940	4.0	10.4	7/8"FSw	1-3/8"FSw	63	193
SR1000	10.0	ZR125KCE-TFD	380-420/3/50	28.8	19.6	118.0	2360	940	4.0	10.4	7/8"FSw	1-3/8"FSw	64	198
SR1200	12.0	ZR144KCE-TFD	380-420/3/50	33.2	22.3	118.0	2950	940	4.0	10.4	7/8"FSw	1-3/8"FSw	64	226
SR1300	13.0	ZR16M3E-TWD	380-420/3/50	35.6	26.0	167.0	2950	940	4.0	10.4	7/8"FSw	1-3/8"FSw	67	258
SR1500	15.0	ZR19M3E-TWD	380-420/3/50	42.1	28.0	198.0	3610	940	4.0	10.4	7/8"FSw	1-5/8"FSw	67	275

NOTES:

- Fan motors are suitable for 220-240/1/50
- R404A pump down capacity shown @ 80% full for 32°C liquid temperature
- Max valve connection size shown. May reduce for different refrigerants & applications
- All noise level ratings are "free field" based at a distance of 3 metres from source and are given as a guide only
- *Capacity ratings are based on suction gas returning to compressor @ 20°C, without liquid sub-cooling. Ratings may be increased by approximately 1% for every 1.1°K of sub-cooling
- Standard condensers fitted. Ratings must not be extrapolated
- Check with Patton's nearest outlet for applications outside the specified range
- Pictured unit configuration subject to change and selected accessory options.

The company reserves the right to make specification changes without notice. 11/03/10